

Hinges

Consisting of Two or Three Parts / Steel

SPECIFICATION

Types

- Type **D**: consisting of three parts
- Type **Z**: consisting of two parts

Steel

Zinc plated, blue passivated

Pin

Brass, nickel-plated

Washer

Brass, nickel-plated

Hexagon nut ISO 4032

Steel zinc plated, blue passivated

Serrated washer DIN 6797

for securing screws

Steel zinc plated, blue passivated

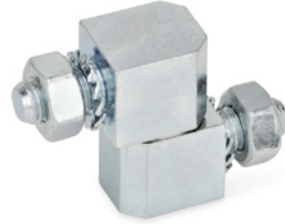

INFORMATION

Hinges GN 129 are used for doors which are flush with the frame on the outside. These hinges are normally arranged to the side of the door.

In the two-part design, the door can be unhinged with two identically arranged hinges.

The three-part hinges, which generally cannot be unhinged and are mounted inside, are suitable for doors and flaps which, as anti-tamper precaution, must not be dismountable from the outside.

TECHNICAL INFORMATION

- List of hinges types (see page 1362)
- Load rating information (see page A35)

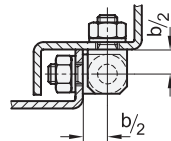
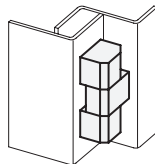
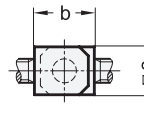
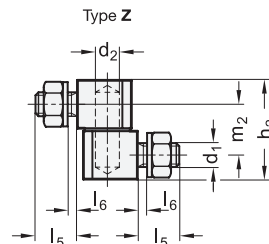
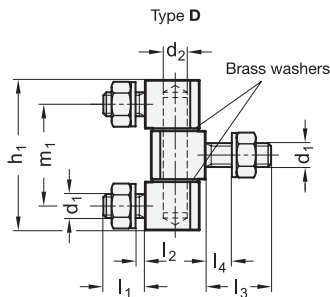

GN 129

Description	s	b	d1	d2	h1	h2	l1	l2	l3	l4 max.	l5	l6	m1	m2	⚖
GN 129-12-D	12	15	M 6	6	39.2	-	10	5	-	9	-	-	27.2	-	57
GN 129-16-D	16	20	M 8	8	49	-	14	8	-	16	-	-	33	-	133
GN 129-12-Z	12	15	M 6	6	-	25.6	-	5	14	-	10	5	-	13.6	38
GN 129-16-Z	16	20	M 8	8	-	32.5	-	8	22	-	14	8	-	16.5	87